



CEILING
LIGHTING
AMBIENCE

MAXIS-S

DATA CENTER GRID

The metal ceiling system has been specifically developed to meet the requirements of data centers. Its load performance is designed to support large quantities of cable trays, busbars and hot aisle containment:

- Uniform load: max. 2kN
- Deflection: 10mm

A airtight and dustproof data center grid MAXIS-S ceiling system also fulfils the requirements for fire protection and sound insulation [if required].

The metal ceiling is available in three standard modules [→ **pages 2-7**]:

- 600x600mm
- 1200x600mm
- 1200 x1200mm

If required, the edge panels can be cut to the correct size on site without affecting the load-bearing capacity [→ **page 9**].

The ceiling panels are secured into place within the aluminum frame, by the lay-on + clip-in system. This grants that panels are fix in position while allowing quick, tool-free access to the ceiling void. To anchor down the panels against additional pressure from below, these can be locked with optional safety clips [→ **page 10**].

The carrier profiles are suspended from the bare ceiling using special quick-lock brackets with M10 threaded rods, which enable easy installation and adjustment to account for height differences [→ **page 9**].

The profiles are designed so that M10 [incl. durlum M10 stainless steel T-nut] or M8 threaded rods for cable trays etc., can be attached directly to them [→ **page 9**].

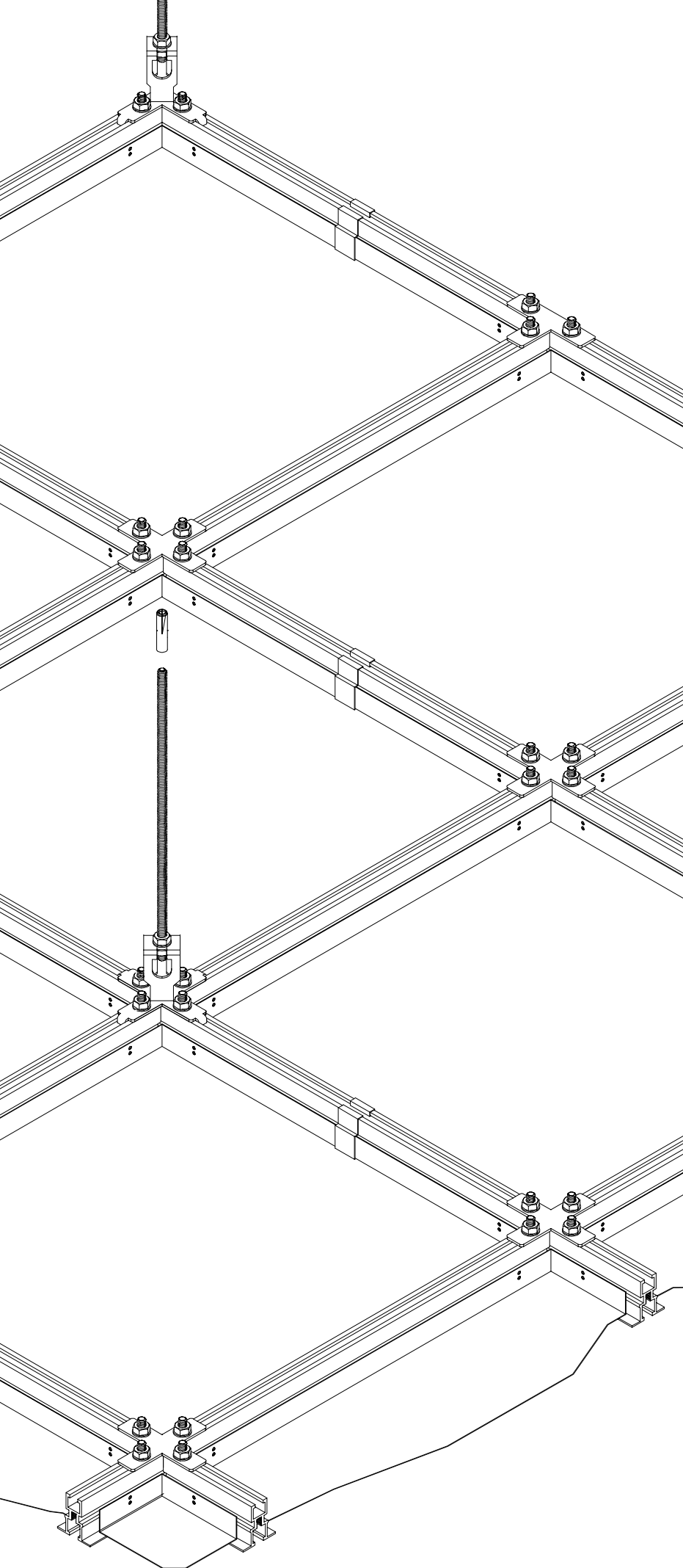

DATA CENTER GRID MAXIS-S | 600X600MM MODULE

600X600MM MODULE

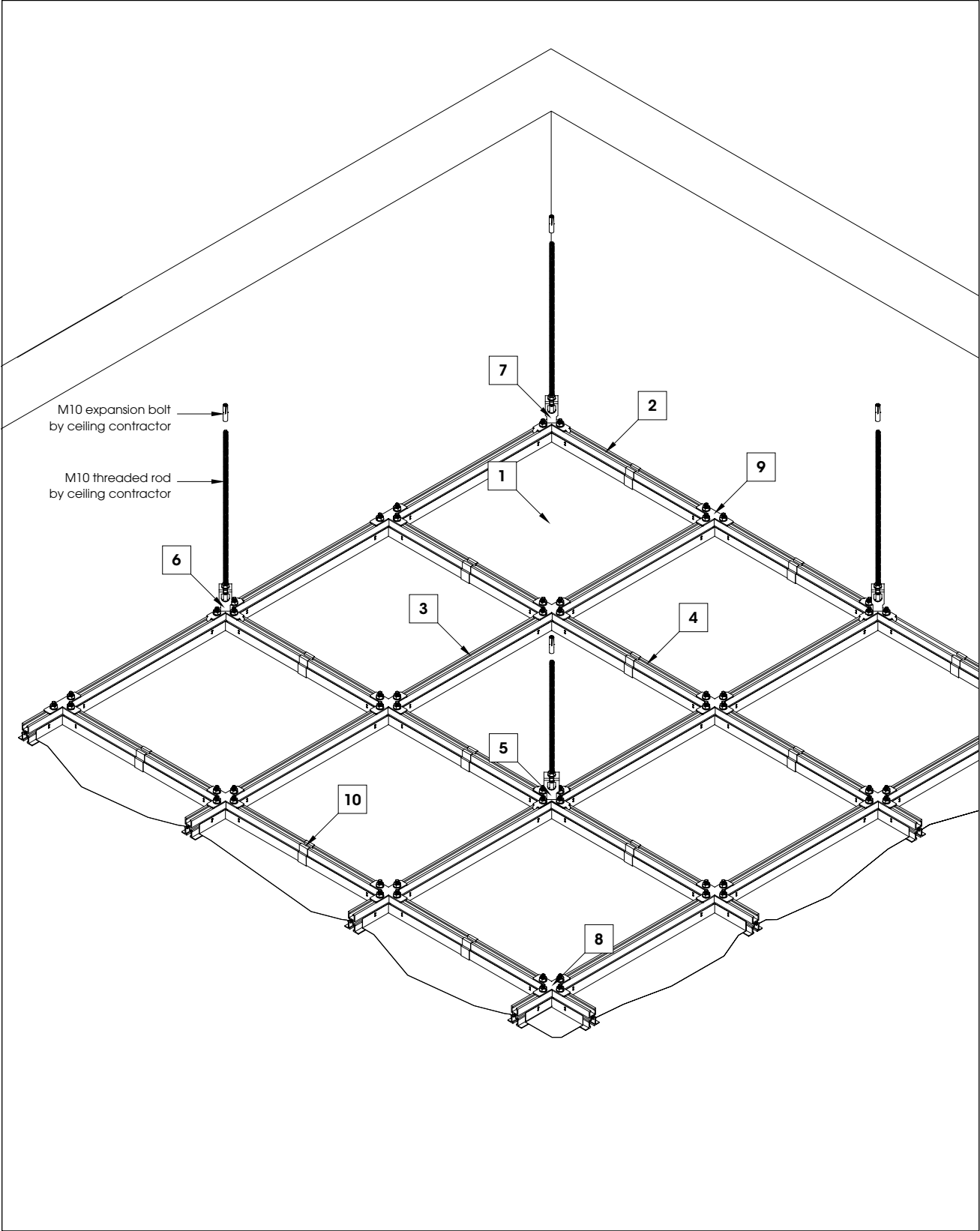

600X600MM MODULE | DATA CENTER GRID MAXIS-S

- 1** DCP03 600x600mm panel
[steel or aluminum; standard color: RAL 9016]

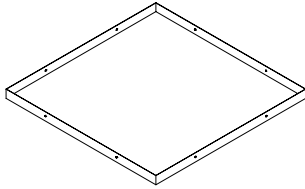

- 2** DC2-M3600 Main grid [aluminum; color of panel]

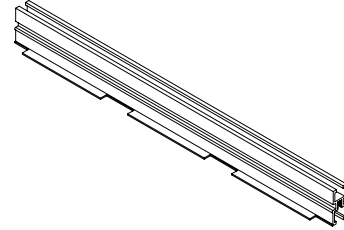

- 3** DC2-C1200 Cross grid [aluminum; color of panel]

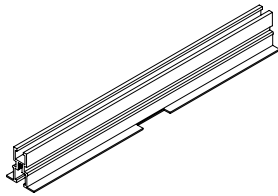

- 4** DC2-C600 Cross grid [aluminum; color of panel]

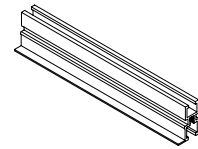

- 5** DC2-XHB Cross bracket [steel; color: matt]

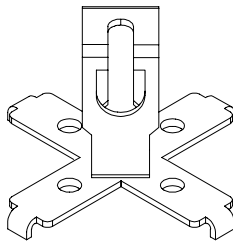

- 6** DC2-THB Tee bracket [steel; color: matt]

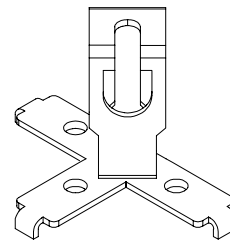

- 7** DC2-LHB L-bracket [steel; color: matt]

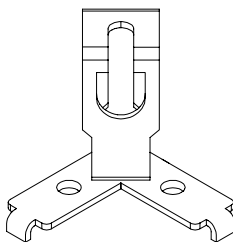

- 8** DC-XFB Cross plate [steel; color: matt]

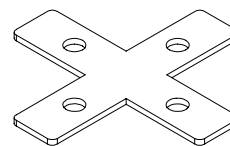

- 9** DC-TFB Tee plate [steel; color: matt]

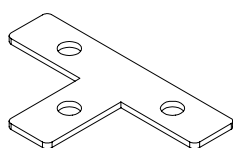

- 10** Optional: DC2-SC Security clip
[spring steel; color: matt]

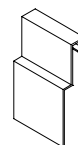

DATA CENTER GRID MAXIS-S | 1200X600MM MODULE

1200X600MM MODULE

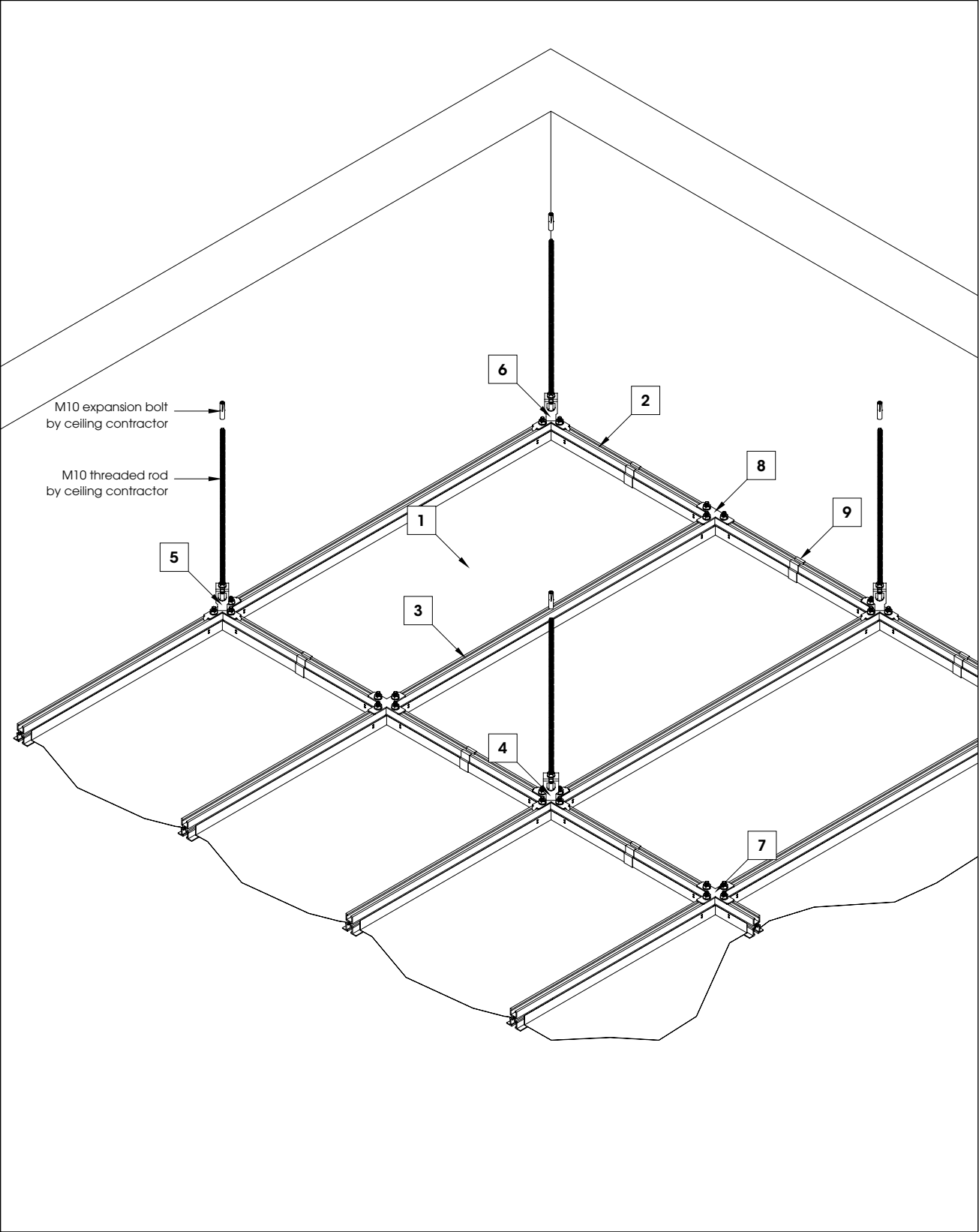

1200X600MM MODULE | DATA CENTER GRID MAXIS-S

1 DCP02 1200x600mm panel
[steel or aluminum; standard clour: RAL 9016]

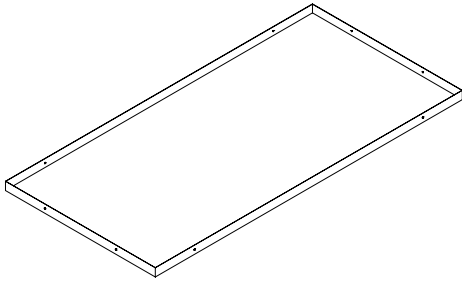

2 DC2-M3600 Main grid [aluminum; color of panel]

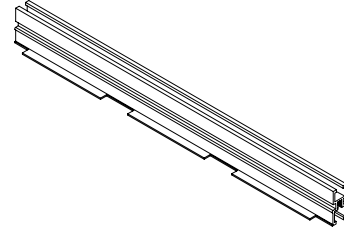

3 DC2-C1200 Cross grid [aluminum; color of panel]

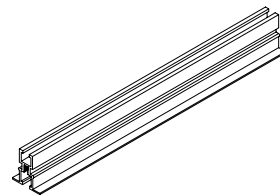

4 DC2-XHB Cross bracket [steel; color: matt]

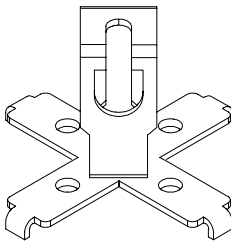

5 DC2-THB Tee bracket [steel; color: matt]

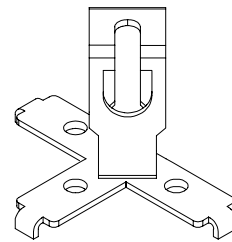

6 DC2-LHB L-bracket [steel; color: matt]

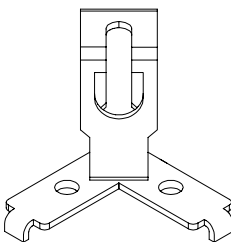

7 DC-XFB Cross plate [steel; color: matt]

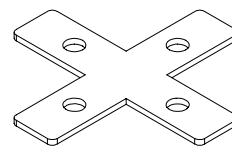

8 DC-TFB Tee plate [steel; color: matt]

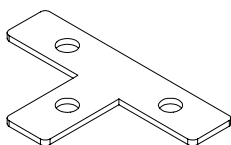

9 Optional: DC2-SC Security clip
[spring steel; color: matt]

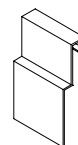

DATA CENTER GRID MAXIS-S | 1200X1200MM MODULE

1200X1200MM MODULE

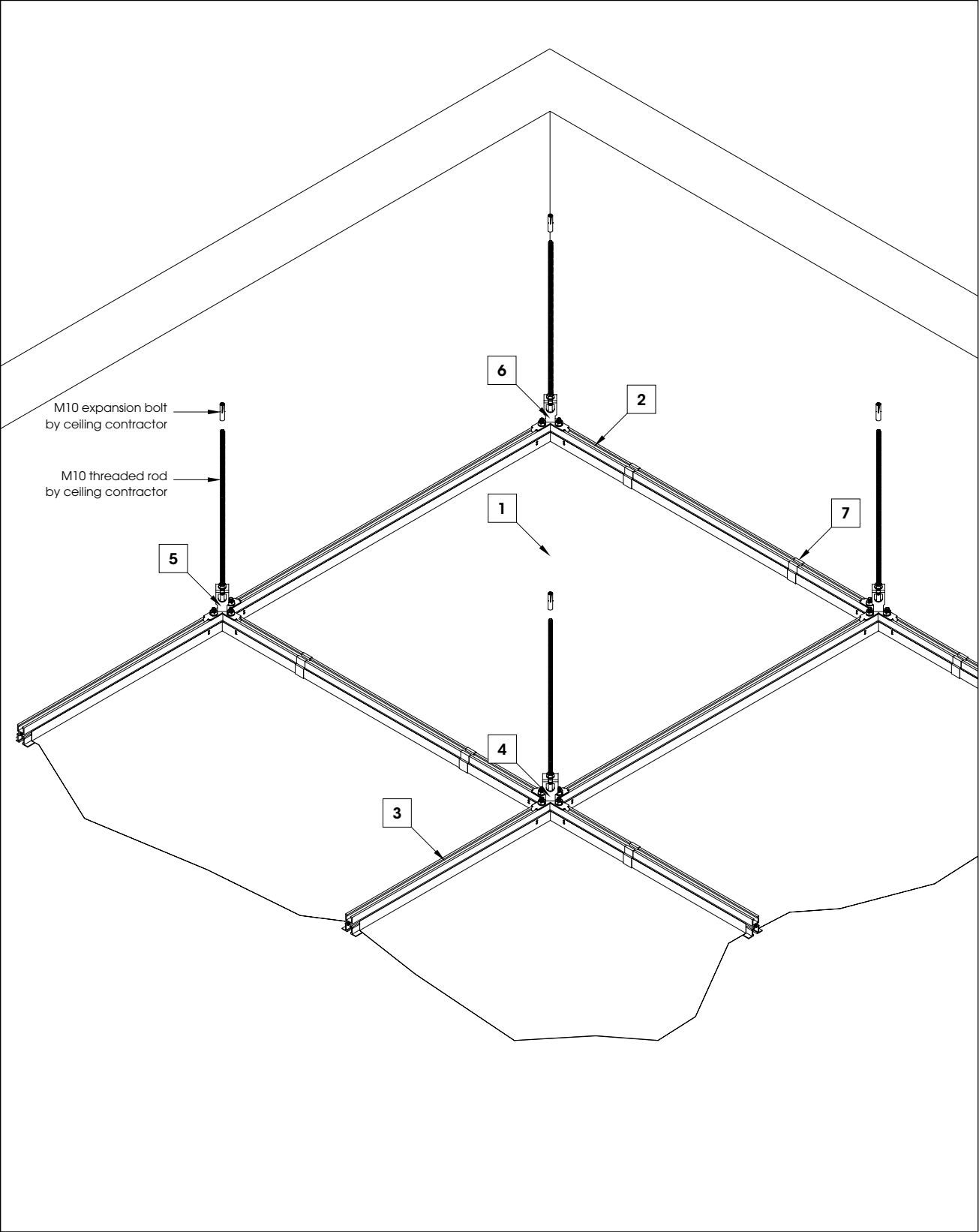

1200X1200MM MODULE | DATA CENTER GRID MAXIS-S

- 1** DCP01 1200x1200mm panel
[steel or aluminum; standard color: RAL 9016]

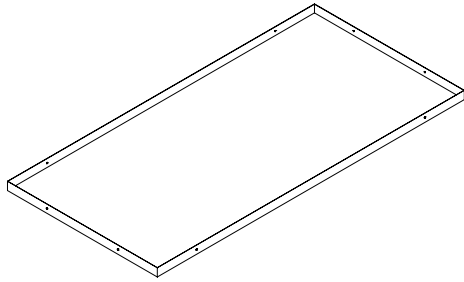

- 2** DC2-M3600 Main grid [aluminum; color of panel]

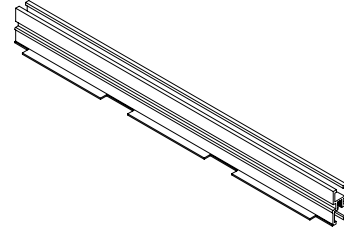

- 3** DC2-C1200 Cross grid [aluminum; color of panel]

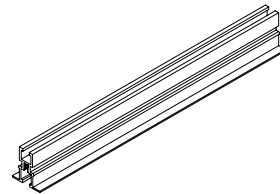

- 4** DC2-XHB Cross bracket [steel; color: matt]

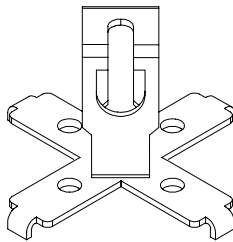

- 5** DC2-THB Tee bracket [steel; color: matt]

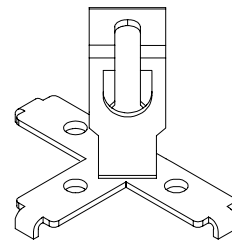

- 6** DC2-LHB L-bracket [steel; color: matt]

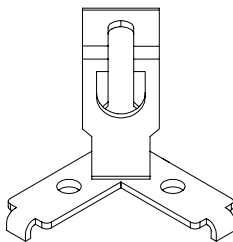

- 7** Optional: DC2-SC Security clip
[spring steel; color: matt]

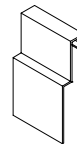

DATA CENTER GRID MAXIS-S | STRUCTURE OF THE SYSTEM

STRUCTURE OF THE SYSTEM, USING THE 600X600 MM MODULE AS AN EXAMPLE

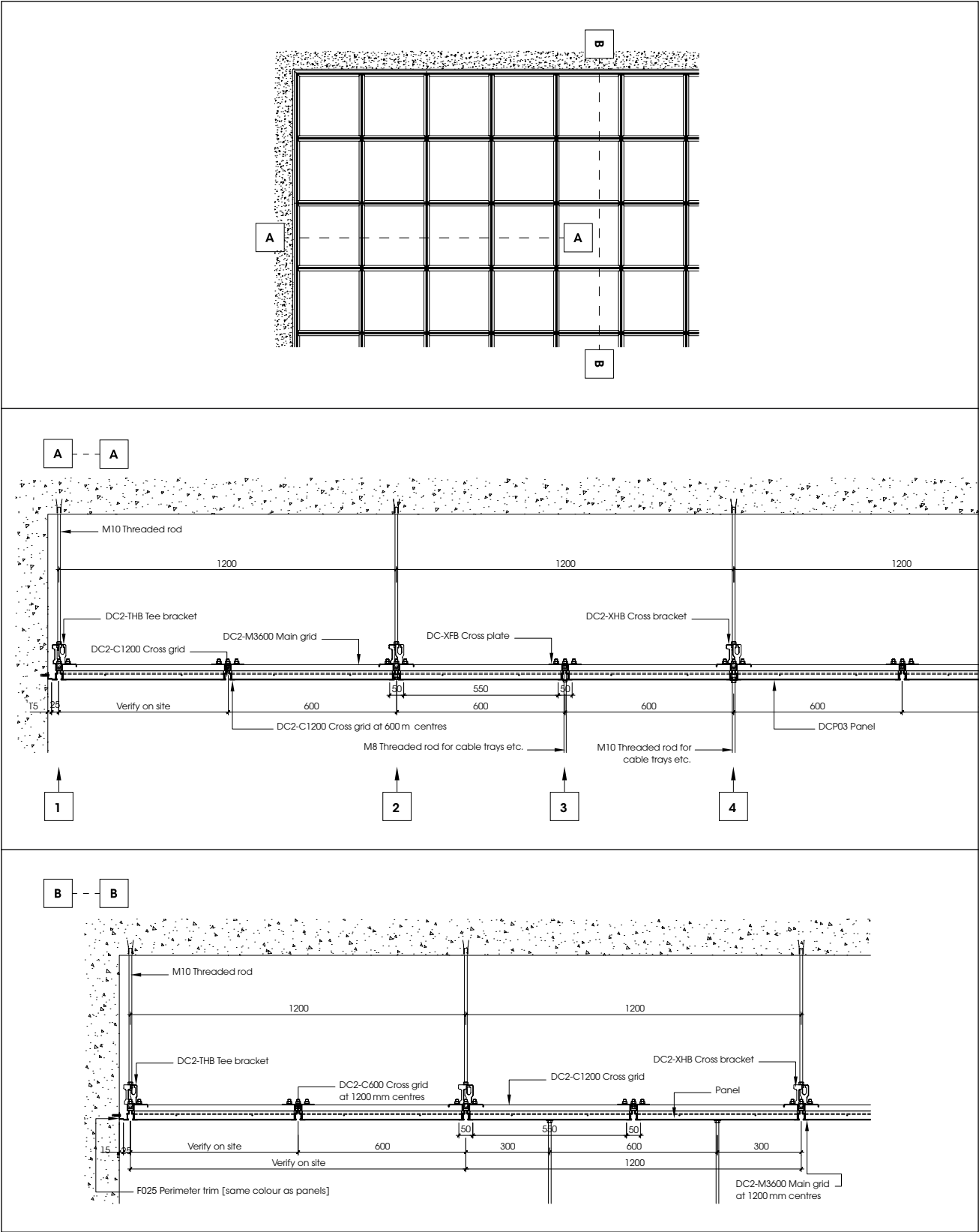

STRUCTURE OF THE SYSTEM | DATA CENTER GRID MAXIS-S

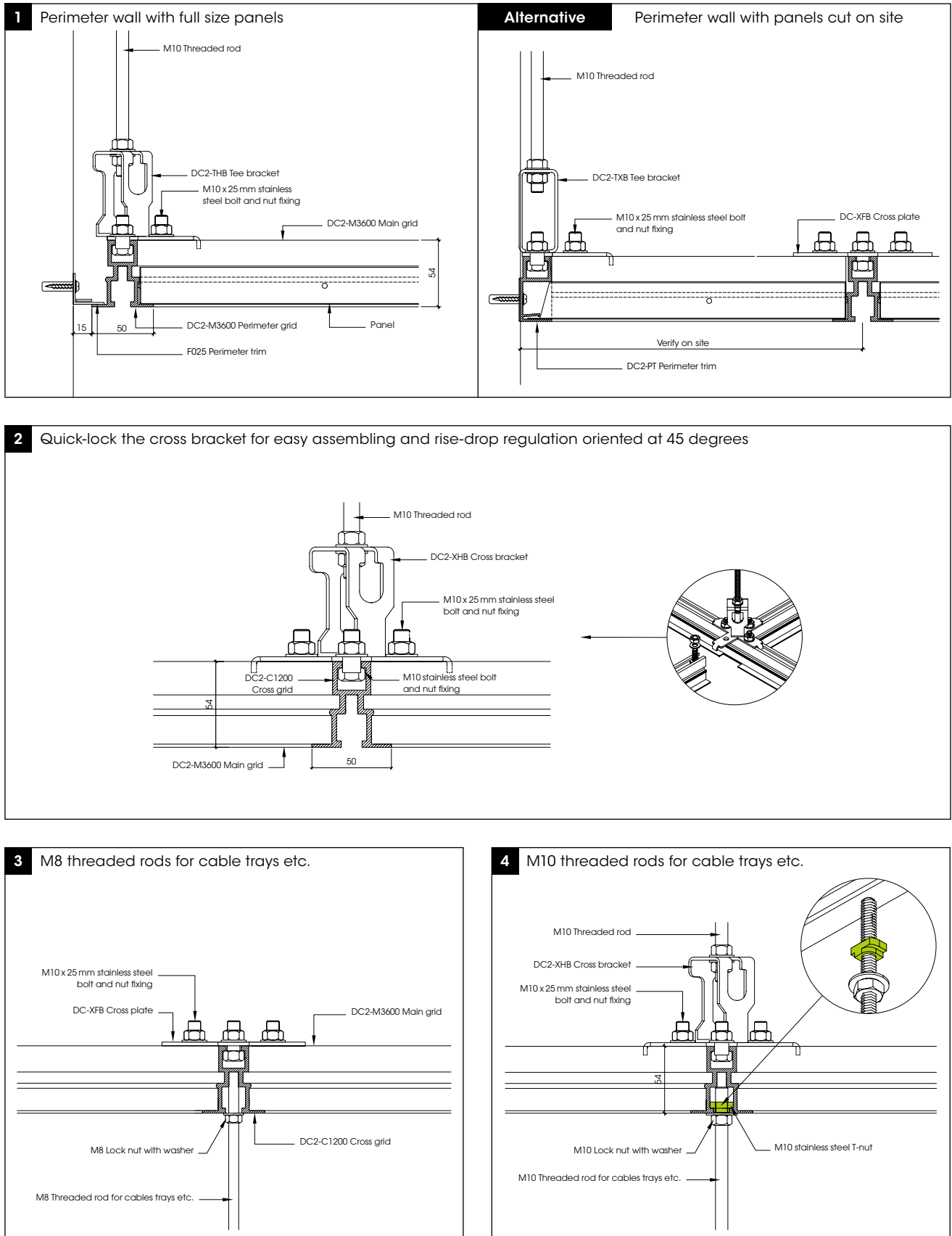

DATA CENTER GRID MAXIS-S | ASSEMBLY AND DISASSEMBLY

ASSEMBLY OF PANELS

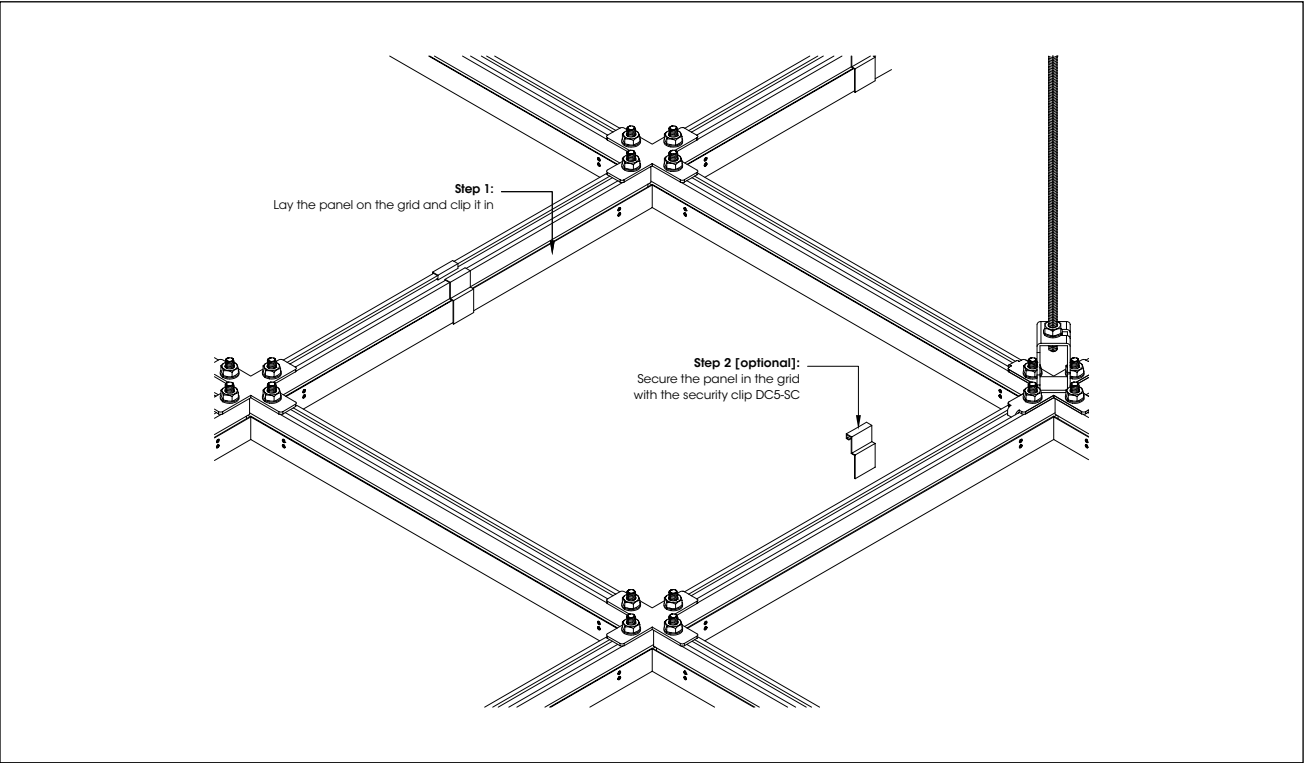

DISASSEMBLY OF PANELS

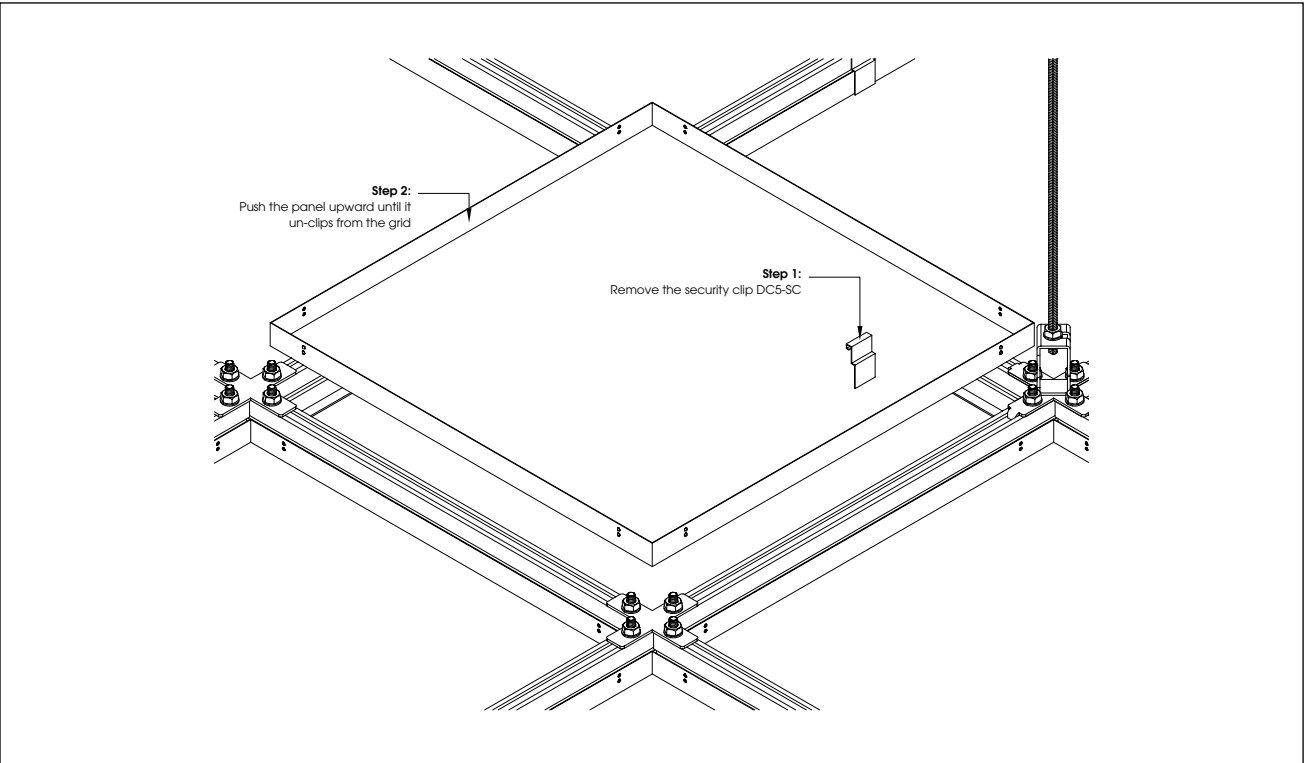

TECHNICAL STANDARDS

- The manufacturing is according to TAIM.
- Complies with BSEN 476, Part 6 and Part 7.

TO BE OBSERVED

- Use only approved mounting plugs.
- Perform mounting according to EN 13964.
- Check construction tolerances.
- Observe local building requirements and regulations of the building inspection authorities.
- Check wall connections for secure attachment, especially for wall movement.

ENVIRONMENT AND HEALTH

Our ceilings are 100% recyclable. They are sustainable, easy to maintain, produce no dust, particles or vapor and are inert and odor-free.

All measurements in mm. We reserve the right to make alternations in dimensions or design.

Errors excepted. All rights reserved.

The information contained in this document is subject to change without notice. durlum makes no warranty of any kind with respect to this information.

durlum shall not be liable for any direct, indirect, incidental, consequential, or other damage alleged in connection with the furnishing or use of this information.

No part of this document may be photocopied, reproduced, or translated to another language without the prior written consent of durlum.

CEILING LIGHTING **AMBIENCE**

durlum Asia – durlum Singapore Private Limited

81 Ubi Ave 4, #10-21 UB. One
408830 Singapore

P +65 6844 4032
E info@durlumasia.com
I durlumasia.com